

Studentlägenhet 23 kvm + förråd 1 kvm

Lgh 0904

1009

1109

1209

FÖRKLARINGAR

- K/F Kyl/Frys
- N Spis med häll/Ugn
- ST Städskåp
- L Linneskåp
- G Garderob
- KH Kapphylla
- br=700* Bröstningshöjd
- E/IT* Elcentral / IT-central
- M* Mediauttag
- LI* Linoleummatta
- PL* Plastmatta

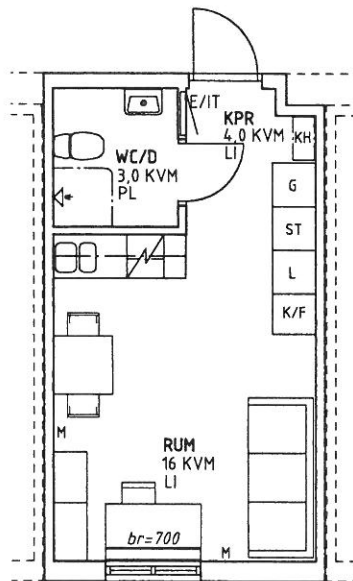

LÄGENHETSPLAN

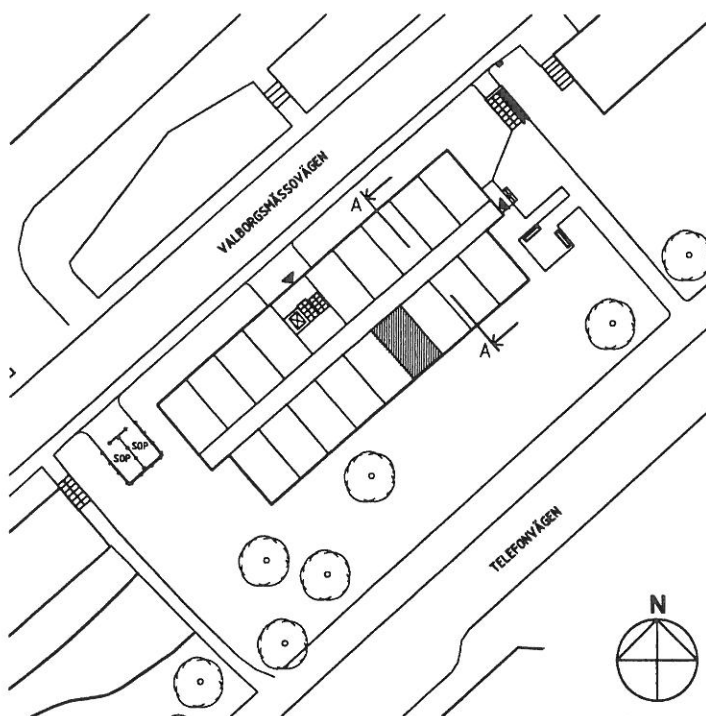
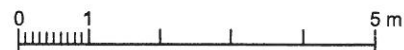

SITUATIONSPLAN

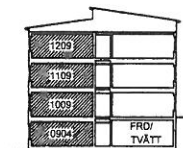

SEKTION

